



CAPELLA

6th GEN ULTRA DEEPWATER DRILLSHIP

RIG OWNED BY AQUADRILL

OPERATED BY VANTAGE DRILLING

More information: marketing@vantagedrilling.com



TECHNICAL SPECIFICATIONS

General Information

Rig Name	Capella (metric)
Year Entered Service	Q4 - 2008
Design	Samsung 10000
Flag	Panama
Classification Agency	ABS
Dimensions	228 x 42 m
Operating Draft	12.00m
Transit draft	8.50m
VDL - Operating	20,000mt
VDL - Survival	20,000mt
VDL - Transit	16,500mt
Transit speed	11.5 kn
Outfitted Max WD	3,050 m
Max Drilling Depth	11,430m
Quarters	180
Helideck Capacity	Chinook 21.3MT

Drilling Package

Derrick	Dual Derrick - NOV
Racking Capacity	13,700 m
Drawworks	NOV, 5750Hp
Rotary Table	1.54 m
Top Drive	NOV Hydralift, HPS 1000 – 106,350Nm

Mud System

Pressure Rating	517 bar
Pumps	4 ea, 1620kW
Solids Control	VSM 300 1 X Quadruple 1 Dual VSM 300

Riser Equipment

Riser tension	1,451 tnf
Riser type/ maker	27.4 m, Shaffer
Riser min ID	0.476 m
Kill / Choke lines min ID	0.114 m
Kill / Choke lines rating	1,034 bar

Storage Capacities

Diesel	5,818 m ³
Drillwater	2,798 m ³
Potable Water	2,800 m ³
Bulk Product	295 m ³
Sack Storage	7,000 sx
Base Oil	500 m ³
Brine	500 m ³
Liquid Mud	1,060 m ³ Active + 1,030 m ³ Reserve
Mudpits (excl slug/mix)	17

Well Control Equipment

Diverter	1.49m, 68bar
BOP	Shaffer NXT – 0.48m – 1,034bar 6 cavities, Vetco H4 Connector
C&K Manifold	1,034 bar

Power Generation

Main Engines	6 Wartsila
Auxillary Engine	MTU 12V 4000 P81
Total Power	6 ea, 7000kW
Main Generators	6 ea 11kv, 7,290KVA
Emergency Power	1 ea, 1,500kW hp

Station Keeping

DP class	DP3
DP control system	Simrad SDPM 22
Thrusters	Rolls Royce

Tubulars

Drill pipe	9,144 m 5 7/8" XT57,NS-1 505 m 5 1/2" HWDP, 505 m 3 1/2"
-------------------	---

Cranes

Pedestal Cranes	4 ea Knuckle Boom
API SWL	85MT
BOP Crane	2 X 175MT
Riser Gantry Crane	NA



CAPELLA

6th GEN ULTRA DEEPWATER DRILLSHIP

RIG OWNED BY AQUADRILL

OPERATED BY VANTAGE DRILLING

More information: marketing@vantagedrilling.com



TECHNICAL SPECIFICATIONS

General Information

Rig Name	Capella (imperial)
Year Entered Service	Q4 - 2008
Design	Samsung 10000
Flag	Panama
Classification Agency	ABS
Dimensions	748 x 138 ft
Operating Draft	39.4 ft
Transit draft	27.9 ft
VDL - Operating	22,047 st
VDL - Survival	16,500 st
VDL - Transit	19,841 st
Transit speed	11.5 kn
Outfitted Max WD	10000 ft
Max Drilling Depth	37500 ft
Quarters	180
Helideck Capacity	Chinook 21.3MT

Drilling Package

Derrick	Dual Derrick - NOV
Racking Capacity	44,950 ft
Drawworks	NOV, 5750Hp
Rotary Table	60.5"
Top Drive	NOV Hydralift, HPS 1000 – 78,450ft-lbs

Mud System

Pressure Rating	7.500 psi
Pumps	4 ea 2200 hp
Solids Control	VSM 300 1 X Quadruple 1 Dual VSM 300

Riser Equipment

Riser tension	3200 kips
Riser type/ maker	90ft, Shaffer
Riser min ID	18 3/4 "
Kill / Choke lines min ID	4.5"
Kill / Choke lines rating	15000 psi

Storage Capacities

Diesel	36,600 bbls
Drillwater	17,600 bbls
Potable Water	8,823 bbls
Bulk Product	31,924 cu ft
Sack Storage	7,000 sx
Base Oil	3140bbls
Brine	3140 bbls
Liquid Mud	6,500 bbls Active + 6,300 bbls Reserve
Mudpits (excl slug/mix)	17

Well Control Equipment

Diverter	59", 1000 psi
BOP	Shaffer NXT - 18 3/4" – 15,000psi 6 cavities, Vetco H 4 Connector
C&K Manifold	15 Kpsi

Power Generation

Main Engines	6 Wartsila
Auxillary Engine	MTU 12V 4000 P81
Total Power	6 ea 9400 hp
Main Generators	6 ea 11kv, 7,290KVA
Emergency Power	1 ea, 2040 hp

Station Keeping

DP class	DP3
DP control system	K-Pos DP-22
Thrusters	Rolls Royce

Tubulars

Drill pipe	30000ft 5 7/8" XT57,NS-1 1659ft 5 1/2" HWDP,1659ft 3 1/2"
------------	--

Cranes

Pedestal Cranes	4 ea Knuckle Boom
API SWL	93.5 st
BOP Crane	2X 193 st
Riser Gantry Crane	NA



CAPELLA
 6th GEN ULTRA DEEPWATER DRILLSHIP
 RIG OWNED BY AQUADRILL
 OPERATED BY VANTAGE DRILLING
 More information: marketing@vantagedrilling.com



GENERAL ARRANGEMENT PROFILE

PROFILE

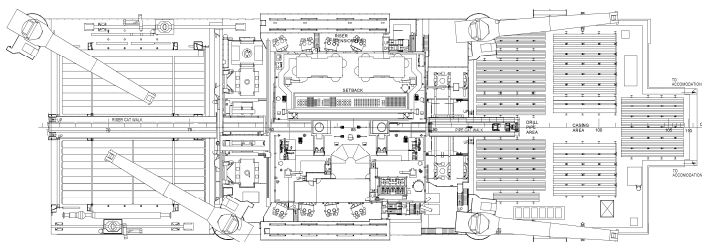
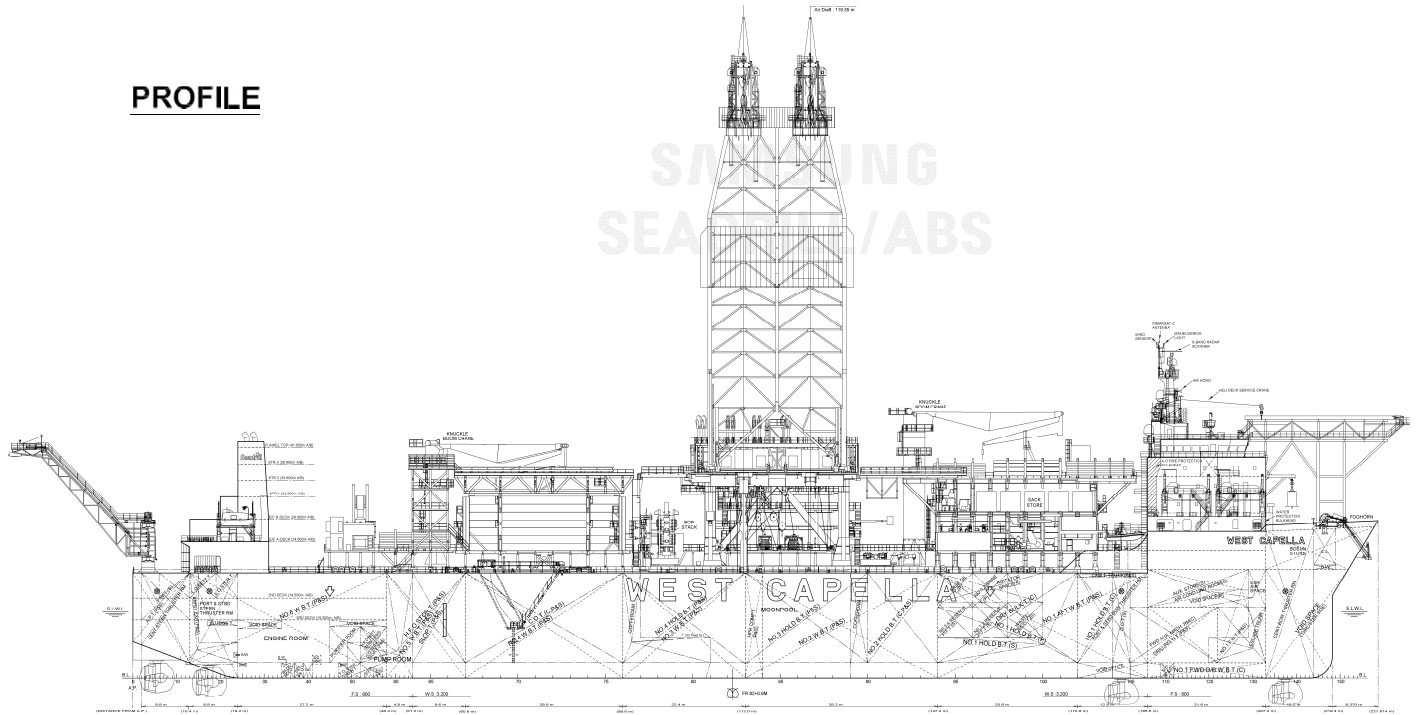

36.0 m A/B PLAN

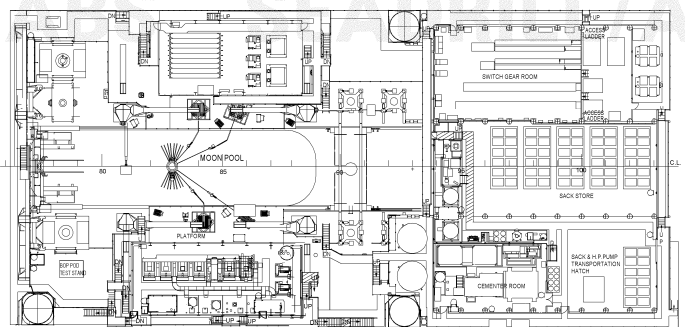

30.000 m A/B PLAN

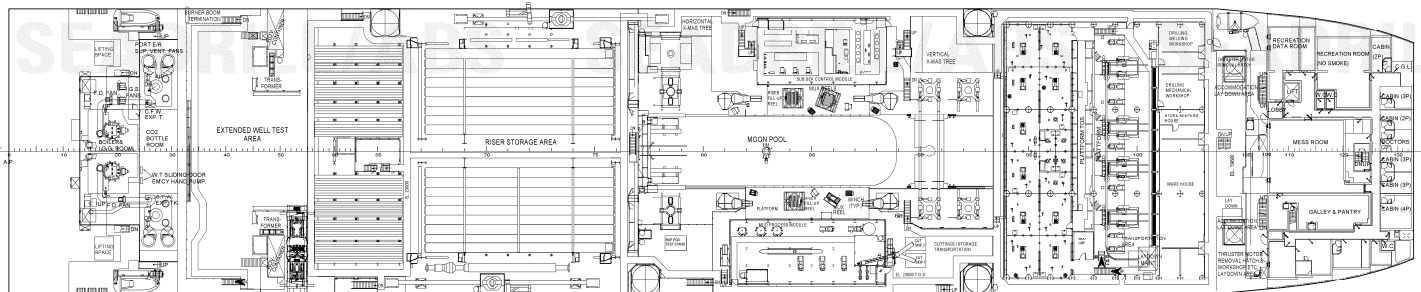

23.0 M A/B PLAN

Revision Date: August 2021

These specifications are intended for general reference purpose only and shall not be contractually binding. Contractor reserves the right to change these specifications at any time without prior notice. All equipment shall be operated and maintained in line with Vantage guidelines and within the limits of OEM specifications.