



POLARIS

6th GEN ULTRA DEEPWATER DRILLSHIP
RIG OWNED BY AQUADRILL
OPERATED BY VANTAGE DRILLING
More information: marketing@vantagedrilling.com



TECHNICAL SPECIFICATIONS

General Information

Rig Name	Polaris (metric)
Year Entered Service	Q2 - 2008
Design	Samsung 10000
Flag	Panama
Classification Agency	ABS
Dimensions	228 x 42 m
Operating Draft	12.00m
Transit draft	8.50m
VDL - Operating	20,000mt
VDL - Survival	20,000mt
VDL - Transit	16,500mt
Transit speed	11.5 kn
Outfitted Max WD	3,050 m
Max Drilling Depth	11,430m
Quarters	200
Helideck Capacity	Chinook 21.3MT

Drilling Package

Derrick	Dual Derrick - NOV
Racking Capacity	13,700 m
Drawworks	NOV, 5750Hp
Rotary Table	1.54 m
Top Drive	NOV Hydralift, HPS 1000 — 106,350Nm

Mud System

Pressure Rating	517 bar
Pumps	4 ea 1620kW
Solids Control	VSM 300 1 X Quadruple 1 Dual VSM 300

Riser Equipment

Riser tension	1,451 tnf
Riser type/ maker	27.4 m , Shaffer
Riser min ID	0.476 m
Kill / Choke lines min ID	0,114 m
Kill / Choke lines rating	1,034 bar

Storage Capacities

Diesel	6,455 m ³
Drillwater	2,869 m ³
Potable Water	1,402 m ³
Bulk Product	904 m ³
Sack Storage	7,000sx
Base Oil	826 m ³
Brine	1,155 m ³
Liquid Mud	1,060 m ³ Active + 1,030 m ³ Reserve
Mudpits (excl slug/mix)	17

Well Control Equipment

Diverter	1.49 m, 68 bar
BOP	Shaffer NXT — 0.48 m — 1,034bar 6 cavities, Vetco H4 Connector
C&K Manifold	1,034 bar

Power Generation

Main Engines	6 Wartsila
Auxillary Engine	MTU 12V 4000 P81
Total Power	6 ea 7000kW
Main Generators	6 ea 11kv, 7290KVA
Emergency Power	1 ea 1,500kW

Station Keeping

DP class	DP3
DP control system	K-Pos DP-22
Thrusters	Rolls Royce

Tubulars

Drill pipe	9,144 m 5 7/8" XT57,NS-1 505 m 5 1/2" HWDP, 505 m 3 1/2"
------------	---

Cranes

Pedestal Cranes	4 ea Knuckle Boom
API SWL	85MT
BOP Crane	2 X 175 MT
Riser Gantry Crane	NA

Revision Date: July 2022

These specifications are intended for general reference purpose only and shall not be contractually binding. Contractor reserves the right to change these specifications at any time without prior notice. All equipment shall be operated and maintained in line with Vantage guidelines and within the limits of OEM specifications.



POLARIS

6th GEN ULTRA DEEPWATER DRILLSHIP

RIG OWNED BY AQUADRILL

OPERATED BY VANTAGE DRILLING

More information: marketing@vantagedrilling.com



TECHNICAL SPECIFICATIONS

General Information

Rig Name	Polaris (imperial)
Year Entered Service	Q2 - 2008
Design	Samsung 10000
Flag	Panama
Classification Agency	ABS
Dimensions	748 x 138 ft
Operating Draft	39.4 ft
Transit draft	27.9 ft
VDL - Operating	22,047 st
VDL - Survival	22,047 st
VDL - Transit	18,188 st
Transit speed	11.5 kn
Outfitted Max WD	10000 ft
Max Drilling Depth	37500 ft
Quarters	200
Helideck Capacity	Chinook 21.3MT

Drilling Package

Derrick	Dual Derrick - NOV
Racking Capacity	44,950 ft
Drawworks	NOV, 5750Hp
Rotary Table	60.5"
Top Drive	NOV Hydralift, HPS 1000 — 78,450ft-lbs

Mud System

Pressure Rating	7.500 psi
Pumps	4 ea 2200 hp
Solids Control	VSM 300 1 X Quadruple
	1 Dual VSM 300

Riser Equipment

Riser tension	3,200 kips
Riser type/ maker	90ft, Shaffer
Riser min ID	18 3/4"
Kill / Choke lines min ID	4.5"
Kill / Choke lines rating	15000 psi

Storage Capacities

Diesel	40,623 bbls
Drillwater	18,055 bbls
Potable Water	8,823 bbls
Bulk Product	31,924 cu ft
Sack Storage	7,000sx
Base Oil	5,200 bbls
Brine	7,264 bbls
Liquid Mud	6,500 bbls Active + 6,300 bbls Reserve
Mudpits (excl slug/mix)	17

Well Control Equipment

Diverter	59", 1000psi
BOP	Shaffer NXT - 18 3/4" — 15,000psi
	6 cavities, Vetco H4 Connector
C&K Manifold	15 Kpsi

Power Generation

Main Engines	6 Wartsila
Auxillary Engine	MTU 12V 4000 P81
Total Power	6 ea 9400 hp
Main Generators	6 ea 11kv, 7,290KVA
Emergency Power	1 ea 2,040 hp

Station Keeping

DP class	DP3
DP control system	K-Pos DP-22
Thrusters	Rolls Royce

Tubulars

Drill pipe	30000ft 5 7/8" XT57,NS-1
	1659ft 5 1/2" HWDP, 1659ft 3 1/2"

Cranes

Pedestal Cranes	4 ea Knuckle Boom
API SWL	93.5 st
BOP Crane	2 X 193 st
Riser Gantry Crane	NA

Revision Date: July 2022

These specifications are intended for general reference purpose only and shall not be contractually binding. Contractor reserves the right to change these specifications at any time without prior notice. All equipment shall be operated and maintained in line with Vantage guidelines and within the limits of OEM specifications.



POLARIS
 6th GEN ULTRA DEEPWATER DRILLSHIP
 RIG OWNED BY AQUADRILL
 OPERATED BY VANTAGE DRILLING
 More information: marketing@vantagedrilling.com



GENERAL ARRANGEMENT PROFILE

PROFILE

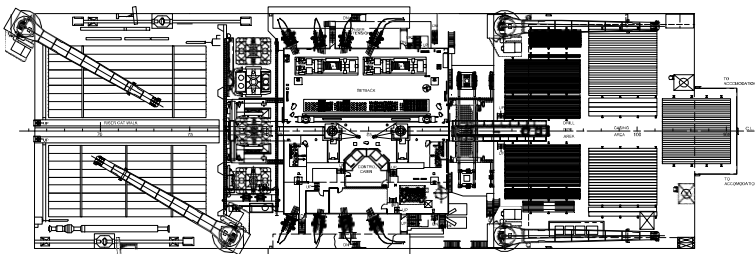
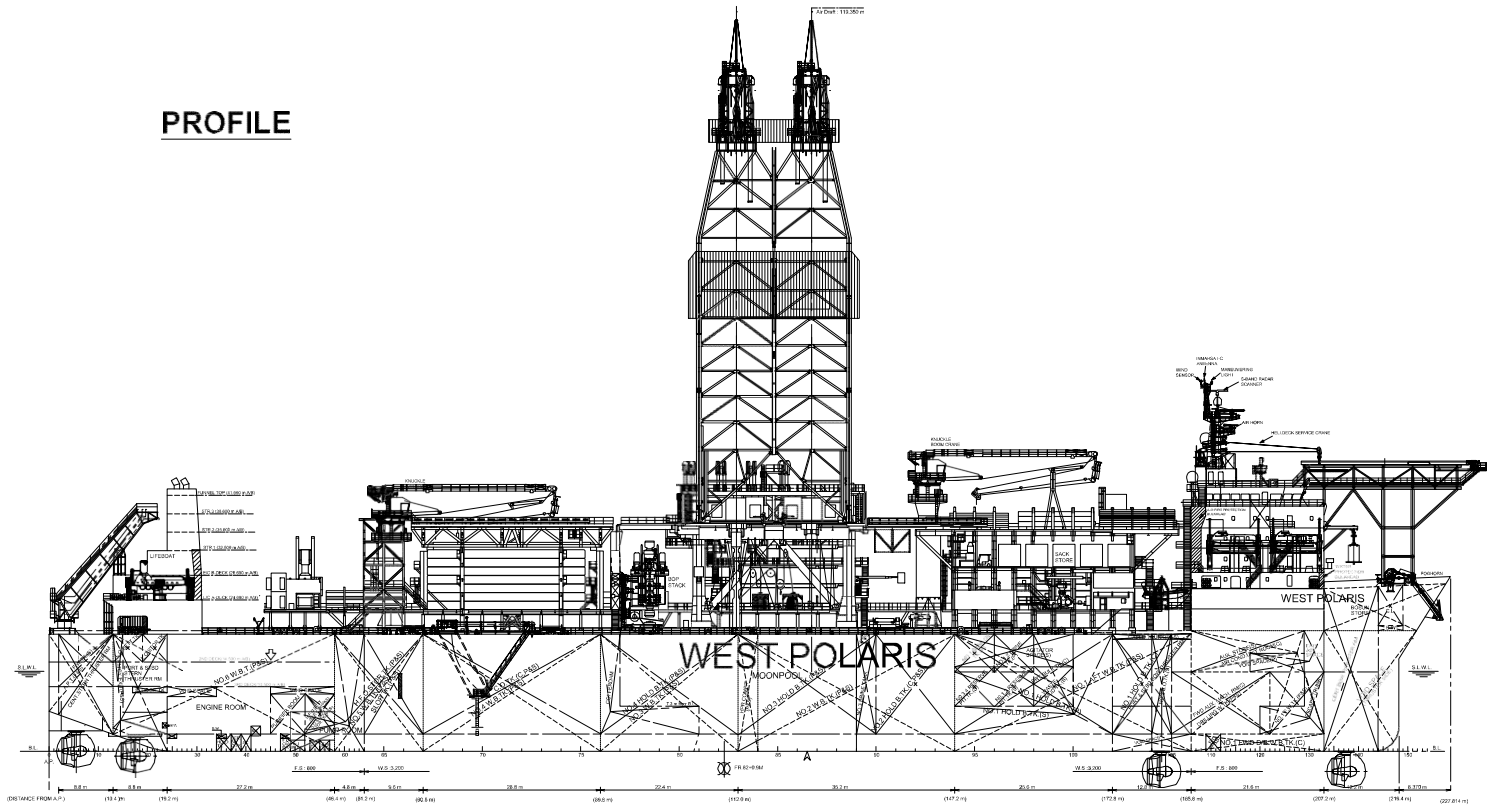

36.0 m A/B PLAN

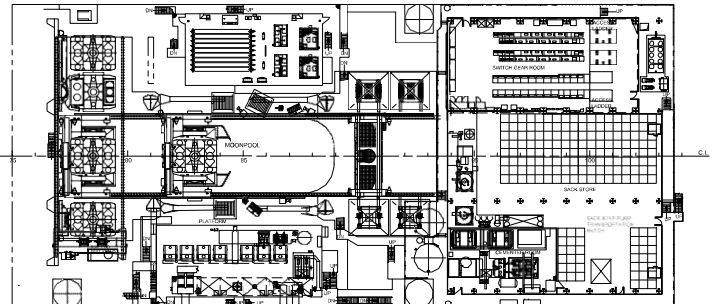

30.000 m A/B PLAN

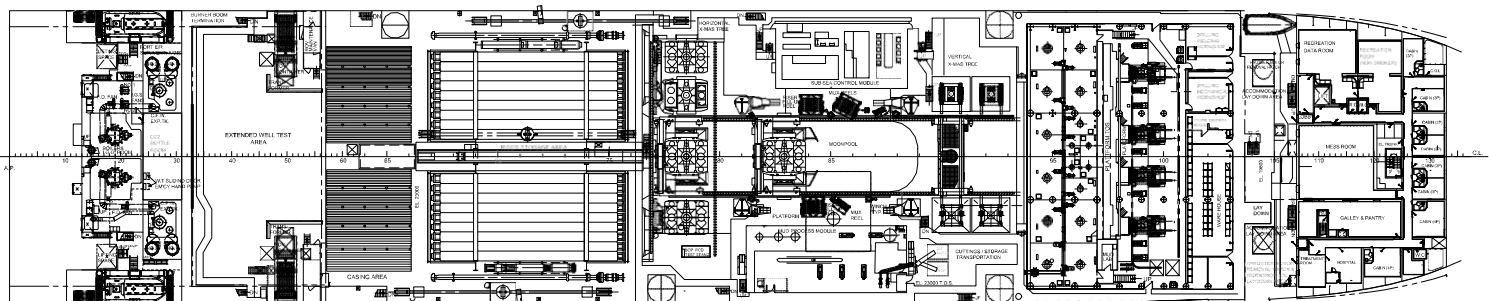

23.0 M A/B PLAN

Revision Date: August 2021

These specifications are intended for general reference purpose only and shall not be contractually binding. Contractor reserves the right to change these specifications at any time without prior notice. All equipment shall be operated and maintained in line with Vantage guidelines and within the limits of OEM specifications.